



REVISIONS

ZONE	REV	DESCRIPTION	DATE	APPROVED
------	-----	-------------	------	----------

SPECIFICATIONS

ELECTRICAL:

FREQUENCY: 0-50 GHZ
 VSWR @ 26.5 GHZ: 1.35:1 MAX
 VSWR @ 40GHZ: 1.6:1 MAX
 VSWR @ 50 GHZ: 1.75:1 MAX
 POWER (AVG) 1 WATT MAX
 POWER DERATES LINEARLY TO <10% AT 100° C
 IMPEDANCE: 50 OHMS
 ATTENUATION ACCURACY:

	0-26.5 GHZ	26.5-40 GHZ	40-50 GHZ
3-10 dB	±0.50 dB	±1.00 dB	±1.50 dB
20 & 30 dB	±0.75 dB	±1.25 dB	±2.00 dB

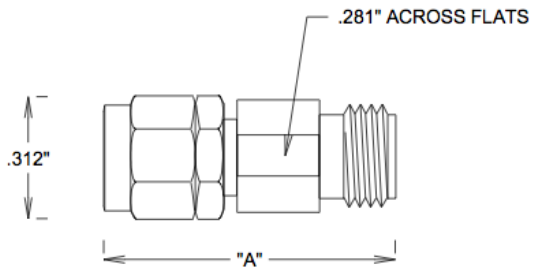

MECHANICAL:

MATERIAL BODY: PASSIVATED STAINLESS STEEL
 MATERIAL RING & CONTACTS: BeCu
 CENTER CONTACT: GOLD PLATED PER MIL-G-45204

ENVIRONMENTAL:

TEMP: -65 C TO +125 C

ROHS COMPLIANT

"A"	
0-20 dB	.871" ±.3"
30 dB	.911" ±.3"

DIMENSIONS IN INCHES 3 PLCS +/- .003 2 PLCS +/- .01 FRACTIONS +/- 1/64 ANGLES +/- 1/2 DEG UNLESS OTHERWISE SPECIFIED	DRAWN D. HEFT	DATE 5/10/11
	CHECKED	
	QA	
	MFG	
MAT'L: SEE NOTES	APPROVED	
FINISH: SEE NOTES		

WEINSCHEL ASSOCIATES 19212 ORBIT DRIVE GAITHERSBURG, MD 20879			
ATTENUATOR, 1W, DC-50 GHz 2.4mm(M-F), WA6			
SIZE A	FSCM NO. 0H3E9	DWG NO. A	REV 1
SCALE NONE	SHEET 1 OF 1		

PROPERTY OF
nVISION INDUSTRIES, INC
 COMPANY CONFIDENTIAL

