

# Fixed Coaxial Attenuator

# WA54CH

DC - 40 GHz

2 WATTS

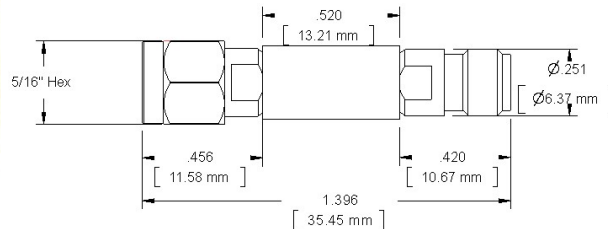
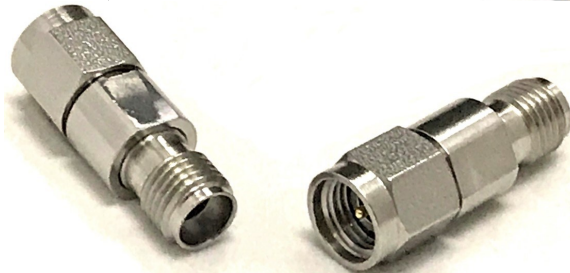

## Features

Precision 2.92mm stainless steel M/F connectors per MIS-STD-348A, interface dimensions mate non-destructively with MIL-PRF-39012. Designed to meet MIL-DTL-3933 environmental specification.

Model WA54CH combines the performance of the WA54 with a more compact package.

## Specifications

**Nominal Impedance:** 50 ohms.

**Frequency Range:** DC - 40 GHz.

**Nominal dB Values:** 1 - 30 dB

**Power Coefficient:** < 0.005 dB/dB/W;  
Bidirectional in power.

**Power Rating:** 2 W average to 25°C ambient temperature, de-rated linearly from 100% at 25°C to 10% at 125°C, 200 W peak (2 µsec pulse width, 0.1% duty cycle).

**Temperature Range:** -65°C to +125°C.

**Temperature Coefficient:** < 0.0005 dB/dB/°C.

**Construction:** Passivated stainless steel body and connectors. Gold plated beryllium copper contacts. RoHs Compliant.

**Calibration:** Insertion Loss and VSWR performed across frequency range. Calibration test data available at additional cost.

## Standard Nominal Values and Deviations:

Attenuation (dB)	Accuracy ± dB	
	DC - 26.5 GHz	26.5 - 40 GHz
0 - 6	0.5	1.0
7 - 20	0.75	1.0
25 and 30	0.8	1.25

## Maximum VSWR:

Frequency (GHz)	VSWR
DC - 26.5	1.3
26.5 - 40.0	1.4

## Dimensions:

### WA54CH

Length:	22.1 (0.87)
Body Diameter:	8 (.315)
Weight:	.005 (.167)

*Note: Dimensions are given in mm (in), or kg (oz). Weight figure is nominal, with our standard connector configuration. Additional connector options may be available.*