

Fixed Coaxial Attenuator

WA86

DC – 22.0 GHz

50 WATTS

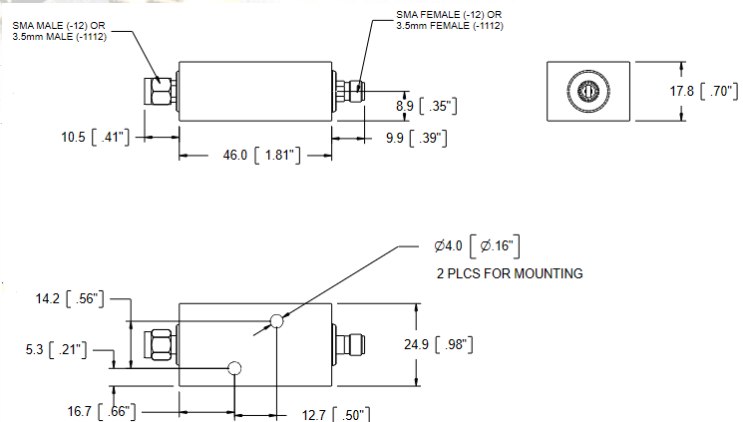

Features

Type SMA and 3.5 mm connectors per MIL-STD-348A, interface dimensions mate nondestructively with MIL-PRF-39012. Designed to meet MIL-DTL-3933 environmental specifications.

Specifications

Nominal Impedance: 50 ohms.

Frequency Range: DC to 22.0 GHz

Nominal dB Values: 3 – 40 dB

Power Coefficient: < 0.0006 dB/dB/W;
Bidirectional in power.

Power Rating: **50 W** Maximum rated average power with case temperature held to a maximum of +90°C. **1 kW** peak power (5 μ sec pulse width, 2.5% duty cycle).

Temperature Range: -55°C to +90°C.

Temperature Coefficient: <0.0004 dB/dB/°C.

Construction: Black anodized aluminum housing. Passivated stainless steel connector body. Gold plated beryllium copper contacts. RoHS Compliant.

Calibration: Insertion Loss and VSWR performed across frequency range. Calibration test data available at additional cost.

Standard Nominal Values and Deviations: Maximum VSWR:

Attenuation (dB)	Accuracy \pm dB
3, 6, 10	+/- 0.8
20, 30	+/- 0.8
40	+/- 1.0

Dimensions:

Frequency (GHz)	VSWR
	WA86
DC - 8.0	1.20
8.0 - 12.4	1.25
12.4 - 22	1.35

Weight: 4.1 (144.6)

Height: 114.3 (4.5)

Width: 137.8 (5.43)

Note: Dimensions are given in mm (in), or kg (oz). Weight figure is nominal, with our standard connector configuration. Additional connector options may be available.