

# Fixed Coaxial Attenuator

# WA3 & WA4

**WA3/6:** DC – 6 GHz

**WA3:** DC – 12.4 GHz

**WA4:** DC – 18.0 GHz

**2 WATTS**

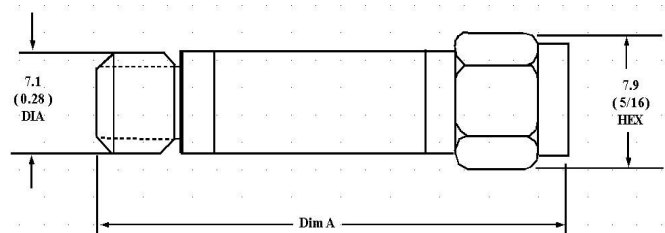

## Features

Type SMA stainless steel M/F connectors per MIL-STD-348A, interface dimensions mate non-destructively with MIL-PRF-39012. Designed to meet MIL-DTL-3933 environmental specification.

## Specifications

**Nominal Impedance:** 50 ohms.

**Frequency Range:** WA3/6: DC - 6 GHz.  
WA3: DC - 12.4 GHz.  
WA4: DC - 18.0 GHz.

**Nominal dB Values:** 1 - 60 dB

**Power Coefficient:** < 0.005 dB/dB/W;  
Bidirectional in power.

**Power Rating:** 2 W average to 25°C ambient temperature, de-rated linearly to 1.25 watts at 75°C and 0.5W at 125°C, 500 W peak (5 µsec pulse width, 0.2% duty cycle).

**Temperature Range:** -55°C to +125°C.

**Temperature Coefficient:** < 0.0004 dB/dB/°C.

**Construction:** Passivated stainless steel body and connectors, gold plated beryllium copper female and male contacts. RoHS Compliant.

**Calibration:** Insertion Loss and VSWR performed across frequency range. Calibration test data available at additional cost.

## Standard Nominal Values and Deviations:

Attenuation (dB)	Accuracy ± dB	
	WA3(/6)	WA4
1 - 6	0.3	0.3
7 - 12	0.3	0.5
13 - 20	0.5	0.7
21 - 40	0.75	1.0
41 - 60	1.0	1.5

Maximum

Frequency (GHz)	VSWR	
	WA3(/6)	WA4
DC - 4.0	1.15	1.15
4.0 - 6.0	1.2	1.2
8.0 - 12.4	1.25	1.25
12.4 - 18.0	N/A	1.35

## VSWR:

Attenuation (dB)	All Models	
	Length (Dim "A")	Weight
1 - 12	31.2 (1.23)	3.9 (.14)
13 - 20	33.3 (1.31)	4.3 (.15)
21 - 30	35.3 (1.41)	4.9 (.17)
31 - 60	43.4 (1.71)	6.5 (.23)

Dimensions: