

Fixed Coaxial Attenuator

WA33L & WA34L

WA 34L: DC - 4.0 GHz
WA 33L: DC - 8.5 GHz

20 WATTS

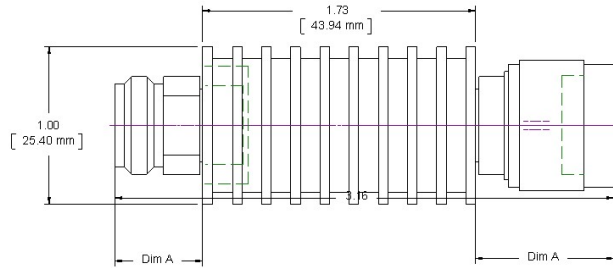

Features

Type N, SMA, TNC, or 7/16 DIN stainless steel connectors per MIL-STD-348A, interface non-destructively with MIL-PRF-39012. Designed to meet MIL-DTL-3933 environmental specification.

Specifications

Nominal Impedance: 50 ohms.

Frequency Range: WA34L: DC - 4.0 GHz
 WA33L: DC - 8.5 GHz

Nominal dB Values: 1 - 30, 40 dB (WA34L)

Power Coefficient: < 0.005 dB/dB/W;
 Bidirectional in power.

Power Rating: 20 W average to 25°C ambient temperature, de-rated linearly to 2 watts 125° C, 5 KW peak (5 µsec pulse width, 0.2% duty cycle).

Temperature Range: -55°C to +125°C.

Temperature Coefficient: < 0.0004 dB/dB/°C.

Construction: Black aluminum alloy body with passivated stainless steel connectors. Gold plated beryllium copper or stainless steel contacts. RoHS compliant.

Calibration: Insertion Loss and VSWR performed across frequency range. Calibration test data available at additional cost.

Low Intermodulation Option: Add -LIM after connector option to specify low intermodulation.

Standard Nominal Values and Deviations:

Attenuation (dB)	Accuracy ± dB	
	WA33L	WA34L
1 - 2	0.8	0.4
3 - 30	1.0	0.6
40	1.3	1.0

Maximum VSWR:

Frequency (GHz)	VSWR	
	WA34L	WA33L
DC - 4.0	1.2	1.2
4.0 - 8.5	1.3	N/A

Dimensions:

Connector Type (- code)	Length
	Dimension 'A'
SMA F -01	9.8 (.39)
SMA M -02	10.9 (.43)
N-Type F -03	14.9 (.59)
N-Type M -04	22.7 (.89)
TNC F -05	17.3 (.68)
TNC M -06	14.1 (.56)
7/16 DIN F -07	30.5 (1.2)
7/16 DIN M -08	31.8 (1.25)

Weight: .12 (4.2)
Diameter: 25.4 (1.0)

Note: Dimensions are given in mm (in), or kg (oz). Weight figure is nominal, with our standard connector configuration. Additional connector options may be available.