

Termination

WA1438

DC - 5.0 GHz

300 WATTS

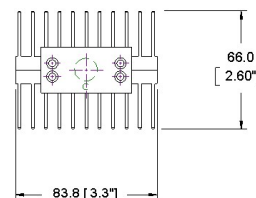
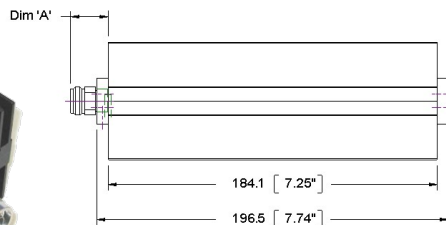

Features

Type N, or DIN 7/16 stainless steel M/F connector per MIL-STD-348A, interface dimensions mate nondestructively with MIL-PRF-39012. Designed to meet MIL-DTL-3933 environmental specification. Unit may be mounted in any position.

Specifications

Nominal Impedance: 50 ohms.

Frequency Range: DC - 5.0 GHz.

Power Rating: **300 W** maximum average rated power to 25°C ambient temperature, de-rated linearly to 25 W at 125°C. **10 kW** peak power (5 usec pulse width, 1.5% duty cycle).

Temperature Range: -55°C to +125°C.

Construction: Black aluminum alloy body with passivated stainless steel connector. Gold plated beryllium copper or stainless steel contacts. RoHS Compliant.

Calibration: VSWR performed across frequency range. Calibration test data available at additional cost.

Low Intermodulation Option: Add -LIM after connector option to specify low intermodulation.

Maximum VSWR:

Frequency (GHz)	VSWR
	WA1438
DC - 2.0	1.15
2.0 - 5.0	1.25

Dimensions:

Connector Type (- code)	Length
	Dimension 'A'
N-Type F -03	14.9 (.59)
N-Type M -04	22.7 (.89)
DIN 7/16 F -07	30.5 (1.2)
DIN 7/16 M -08	31.8 (1.25)

Weight: 1.28 (45.2)
Height: 66 (2.6)
Width: 83.8 (3.3)

Note: Dimensions are given in mm (in), or g (oz). Weight figure is nominal, with our standard connector configuration. Additional connector options may be available.